

VENCLOSURE

VENTED ENCLOSURE

INSTALLATION INSTRUCTIONS & PARTS LIST

FOR MODELS

7.5 MCGA (60HZ) AND 6.2 MCGA (50HZ)

5.0 MCGA (60HZ) AND 4.2 MCGA (50HZ)

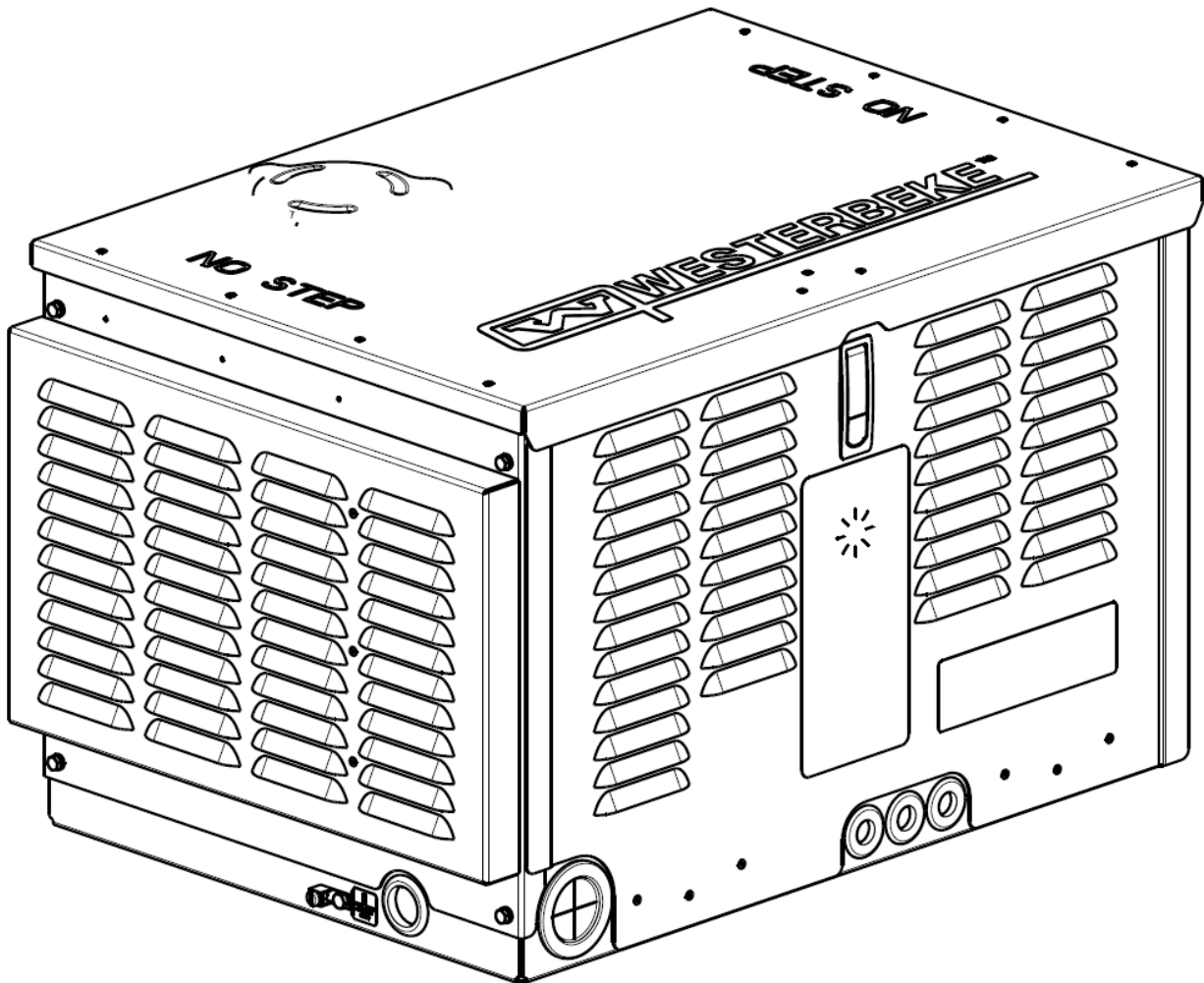



DANGER

THE FOLLOWING INSTRUCTIONS ARE INTENDED FOR USE BY EXPERIENCED, KNOWLEDGEABLE TECHNICIANS. IMPROPER INSTALLATION, ADJUSTMENT, MAINTENANCE OR SERVICE, AND UNAUTHORIZED ALTERATIONS OR MODIFICATIONS CAN CAUSE PROPERTY DAMAGE, INJURY, OR DEATH AND WILL VOID ANY WARRANTY. READ THE INSTALLATION, OPERATING, AND SERVICE INSTRUCTIONS THOROUGHLY BEFORE INSTALLING OR SERVICING EQUIPMENT.



WARNING

- ALL APPROPRIATE SAFETY PROCEDURES MUST BE FOLLOWED.
- ALWAYS STOP THE ENGINE BEFORE PERFORMING ANY SERVICE AND ALLOW IT TO COOL DOWN BEFORE YOU BEGIN WORK TO PREVENT BURNING YOURSELF.
- ALWAYS DISCONNECT YOUR BATTERIES, NEGATIVE TERMINAL FIRST.
- REMOVE ANY LOOSE FITTING CLOTHING OR JEWELRY THAT COULD BECOME ENTANGLED IN YOUR MOTOR OR OTHER MACHINERY.
- STAY CLEAR OF ALL MOVING PARTS.
- WEAR ANSI-APPROVED SAFETY GLASSES OR EYEWEAR AND PROPER SAFETY EQUIPMENT AT ALL TIMES.
- BE SURE THAT YOUR WORK AREA IS SUFFICIENTLY VENTILATED AND THAT NO FUELS, SOLVENTS, OR VAPORS/FUMES ARE PRESENT IN AND AROUND YOUR WORK AREA.
- DO NOT ATTEMPT INSTALLATION WHILE USING ALCOHOL OR MEDICATIONS THAT COULD IMPAIR YOUR JUDGMENT OR REACTION TIME.
- NEVER WORK UNDERNEATH AN ENGINE OR GENERATOR WHILE SUSPENDED FROM THE LIFTING EYE.
- USE THE RIGHT TOOL FOR THE JOB. USE OF IMPROPER TOOLS COULD RESULT IN DAMAGE OR INJURY.



WARNING

BREATHING GASOLINE OR DIESEL EXHAUST EXPOSES YOU TO CHEMICALS KNOWN TO THE STATE OF CALIFORNIA TO CAUSE CANCER AND BIRTH DEFECTS OR OTHER REPRODUCTIVE HARM.

- ALWAYS START AND OPERATE THE ENGINE IN A WELL-VENTILATED AREA
- IF IN AN ENCLOSED AREA, VENT THE EXHAUST TO THE OUTSIDE
- DO NOT MODIFY OR TAMPER WITH THE EXHAUST SYSTEM
- DO NOT IDLE THE ENGINE EXCEPT AS NECESSARY

FOR MORE INFORMATION GO TO WWW.P65WARNINGS.CA.GOV

SCHEMATIC

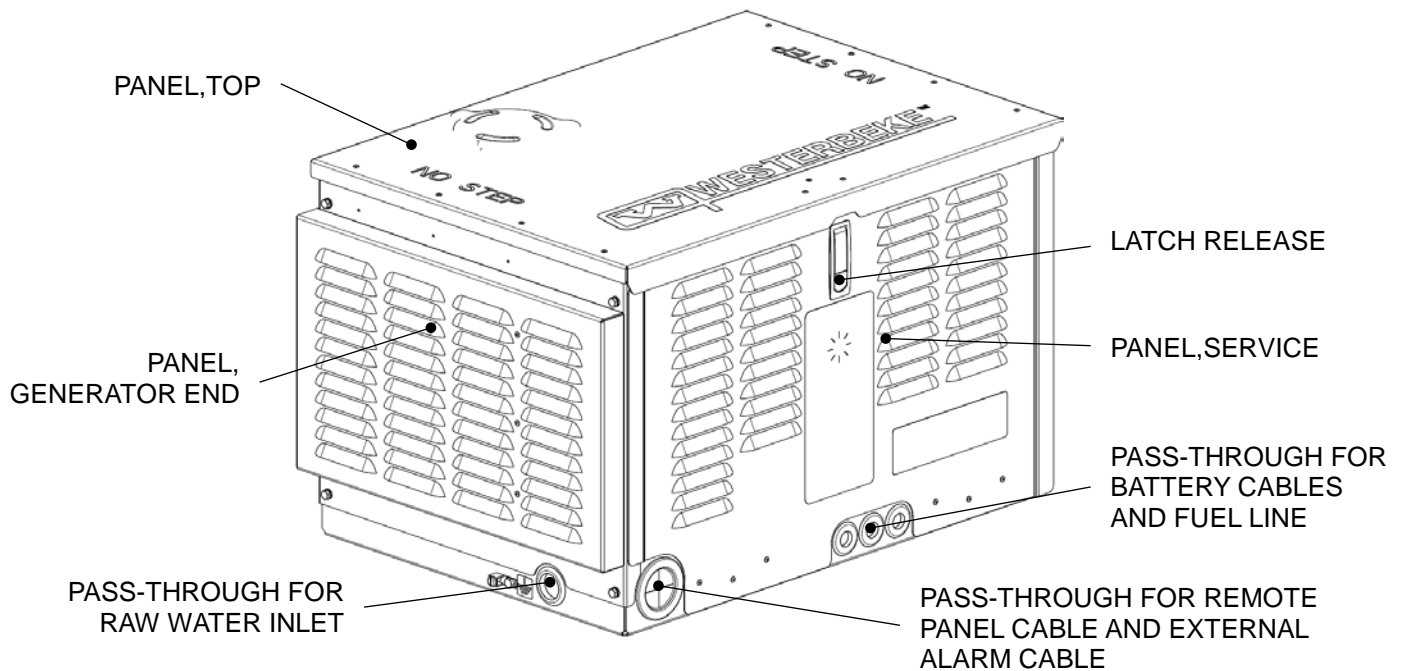

GENERATOR END (SERVICE SIDE VIEW)

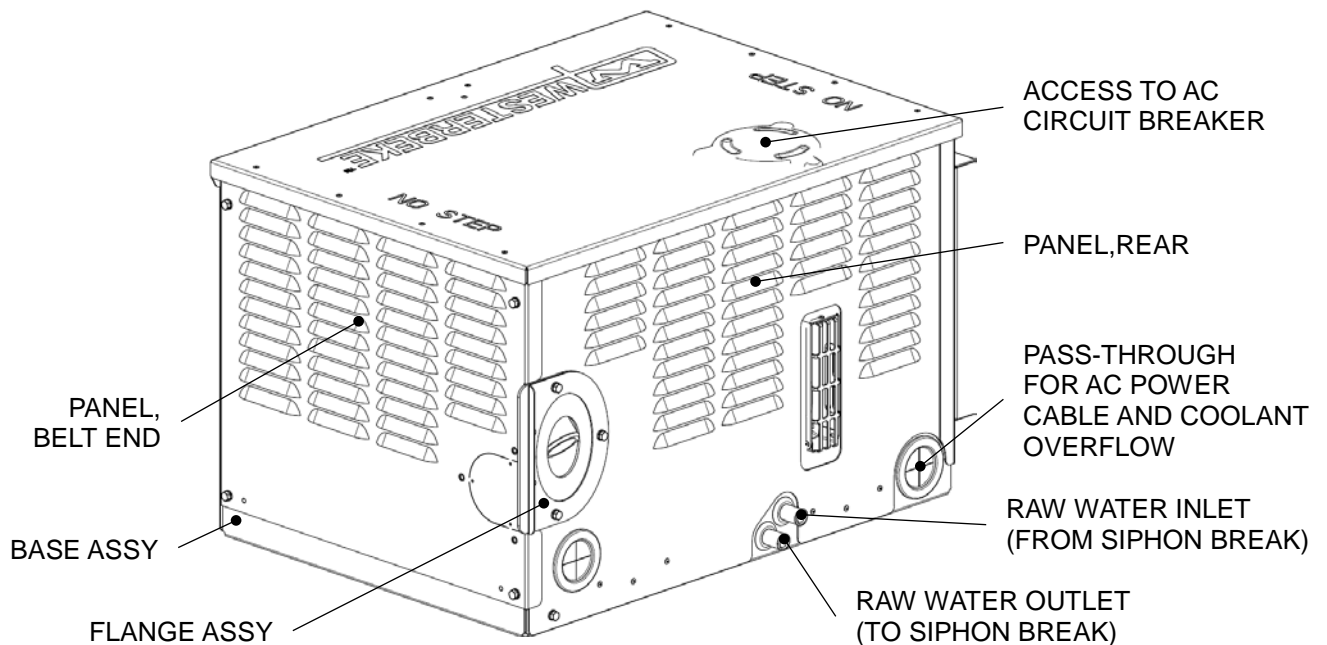

BELT END (NON-SERVICE SIDE VIEW)

DISASSEMBLY

Venclosure equipped Gensets are shipped with the Venclosure fully assembled. Some disassembly is required for installation.

1. Push the *LATCH RELEASE* button on the *PANEL, SERVICE*. Using latch handle, lift up, then rotate bottom away from Venclosure, then lower and remove panel.
2. Remove three screws (short) on *FLANGE ASSY* and remove flange assy.
3. Remove top two screws (long) on *PANEL, BELT END*.
4. Remove top two screws (long) on *PANEL, GENERATOR END*.
5. Remove *PANEL, TOP*.
6. Remove lower two screws (long) on *PANEL, BELT END* and remove panel.
7. Remove lower two screws (long) on *PANEL, GENERATOR END* and remove panel.
8. Remove screw (short) on *PANEL, REAR*, lift up and remove panel.

INSTALLATION OF GENSET

Mount Genset and make connections in accordance with Westerbeke's *INSTALLATION MANUAL FOR MARINE ENGINES & GENERATORS*, publication number 43268. Route all Genset connections through indicated pass-throughs in *BASE ASSY*. Install *FLANGE ASSY* over wet exhaust hose prior to connecting wet exhaust hose to Genset exhaust. *FLANGE ASSY*'s rubber side shall face Venclosure. Use provided hose and hose clamps to connect *RAW WATER OUTLET (TO SIPHON BREAK)* with *RAW WATER INLET (FROM SIPHON BREAK)* if no siphon break is utilized.

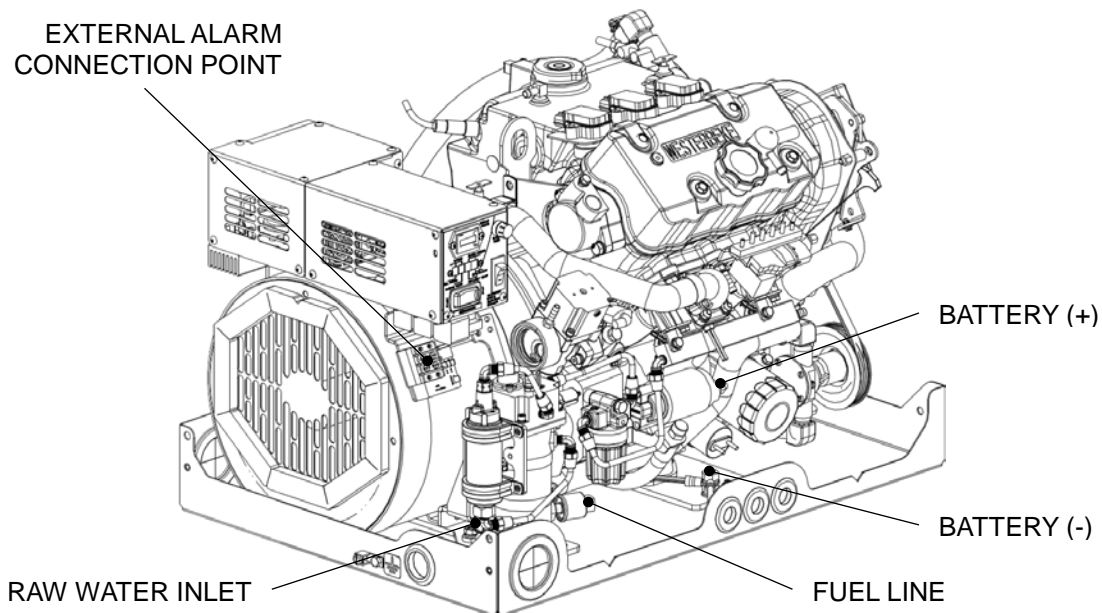

GENERATOR END (SERVICE SIDE VIEW)

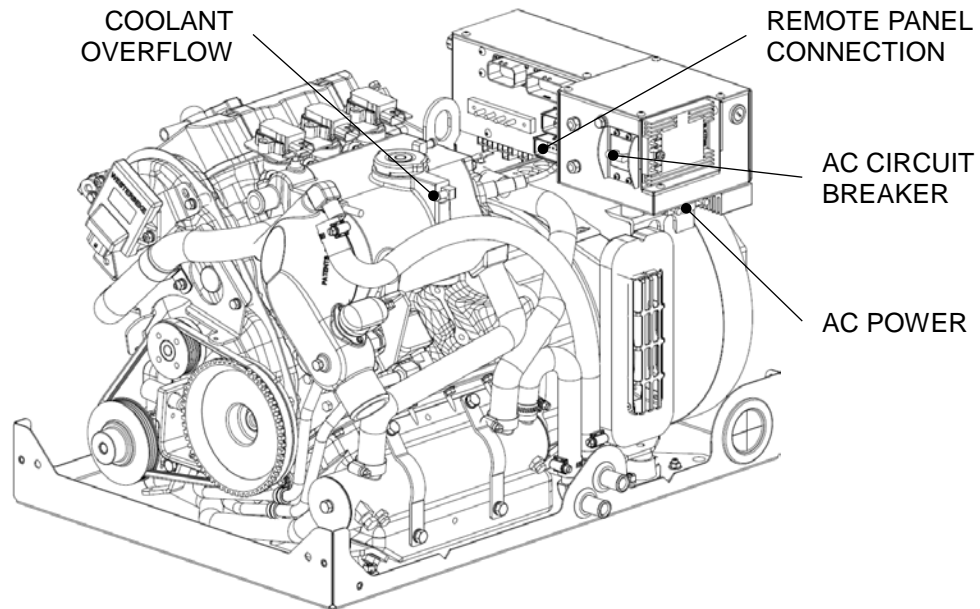

BELT END (NON-SERVICE SIDE VIEW)

VENCLOSURE ASSEMBLY

1. Install *PANEL, REAR* onto *BASE ASSY*. Ensure both guides on bottom engage vertical wall of the *BASE ASSY*. Install and tighten screw (short) with lock washer and washer through *PANEL, REAR* into *BASE ASSY* (see **FIGURE 1**).
2. Install *PANEL, GENERATOR END* onto *BASE ASSY*. Ensure both alignment pins engage. Install and hand-tighten two lower screws (long) with lock washer and washer through *PANEL, GENERATOR END* into *BASE ASSY* (see **FIGURE 1**).
3. Install *PANEL, BELT END* onto *BASE ASSY*. Ensure both alignment pins engage. Install and hand-tighten two lower screws (long) with lock washer and washer through *PANEL, BELT END* into *BASE ASSY* (see **FIGURE 2**).
4. Install *PANEL, TOP* by inserting rear brackets into upper slots in *PANEL, REAR*. Ensure *PANEL, TOP* wraps over *PANEL, GENERATOR END*, *PANEL, REAR* and *PANEL, BELT END* when fully installed (see **FIGURE 3**).
5. Install and tighten two upper screws (long) with lock washer and washer through *PANEL, GENERATOR END* into *PANEL, TOP*. Tighten two lower screws (long) through *PANEL, GENERATOR END* into *BASE ASSY*.
6. Install and tighten two upper screws (long) with lock washer and washer through *PANEL, BELT END* into *PANEL, TOP*. Tighten two lower screws (long) through *PANEL, BELT END* into *BASE ASSY*.
7. Install and tighten three screws (short) with lock washer and washer through *FLANGE ASSY* into *PANEL*.
8. Using latch handle insert top of *PANEL, SERVICE* under *PANEL, TOP*, lift up, rotate bottom towards Venclosure and lower panel. Ensure both tabs on bottom engage vertical wall of the *BASE ASSY*. Lock the latch. Adjust latch tension as needed.

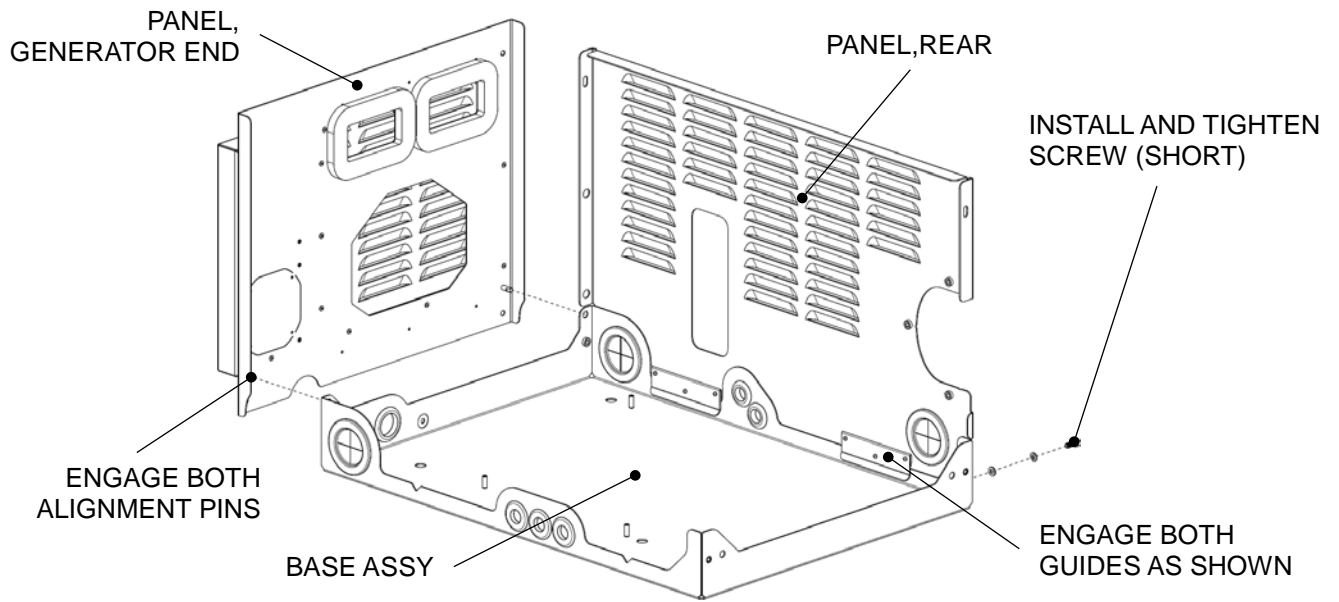

FIGURE 1

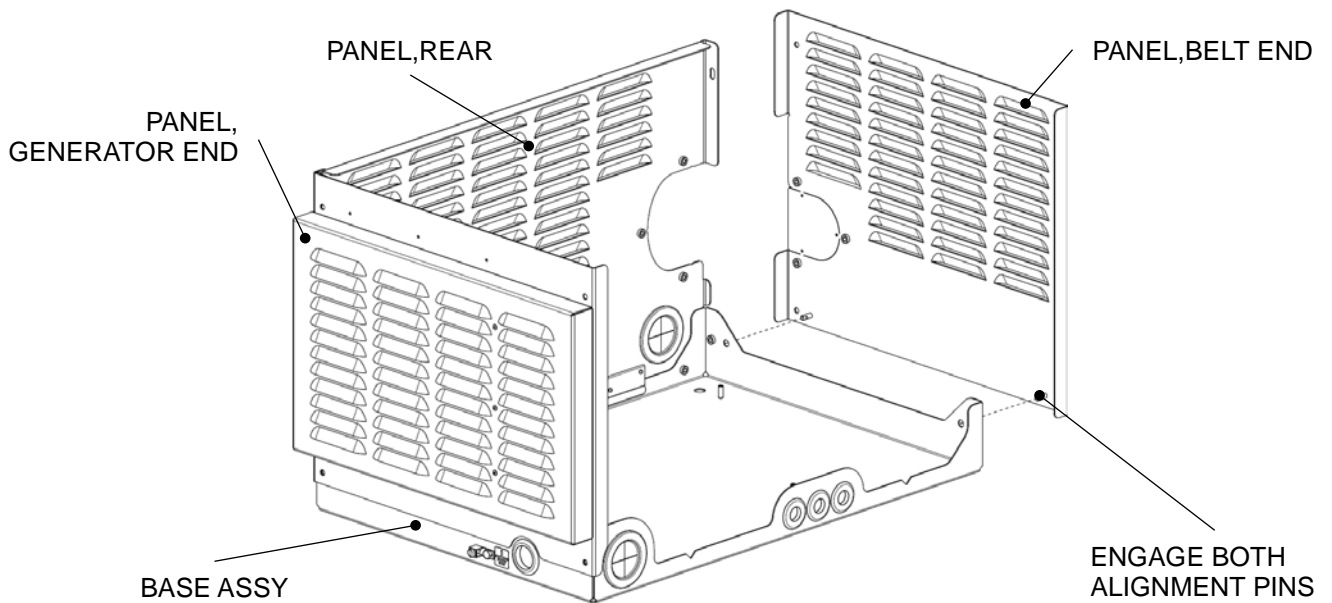

FIGURE 2

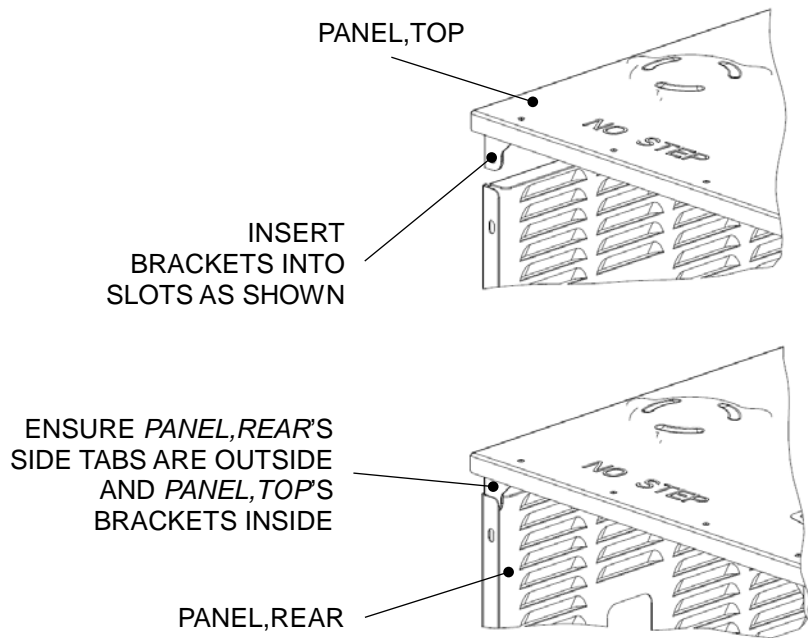

FIGURE 3

PARTS LIST

REF	PART #	PART NAME	NOTES
1A	56860	BASE ASSY	UP TO MFG DATE CODE SB (FEB 2019)
1B	57082	BASE ASSY	MFG DATE CODE SC (MAR 2019) AND LATER
2	57036	NUT M 6x1 FLANGED	MFG DATE CODE SC (MAR 2019) AND LATER
3	31501	CAPSCREW 1/4NCx1/2	
4	47082	LABEL,GROUND SYMBOL	
5	49543	TERMINAL,GROUND LUG	
6	39498	BUSHING, 2.50 HOLE	
7	56836	GROMMET, 1-1/4 HOLE	
8	231907	LOCKWASHER 1/4	
9	52968	WIRE,GROUND 24.0" LG	
10	200120	NUT 1/4-20 NC KEPS	
11	56835	GROMMET 1-1/4ID	
12	56834	GROMMET 1-1/16ID	
13A	56861	PANEL,REAR	SIDEX MODELS
13B	56862	PANEL,REAR	REARX MODELS
14A	56866	PANEL,BELT END	SIDEX MODELS
14B	56865	PANEL,BELT END	REARX MODELS
15	56815	ALIGNMENT PIN	
16A	56863	PANEL,GENERATOR END	7.5/6.2 MCGA
16B	56864	PANEL,GENERATOR END	5.0/4.2 MCGA
17	56813	SEAL,CONTROL PANEL	
18	56870	PANEL,SERVICE	
19	56843	LATCH	
20	49548	GASKET,PANEL EDGE	
21	56872	LABEL,LOGO EFI LOW-CO	
22	56856	LABEL,FIREPORT WARNING	
23	56867	PANEL,TOP	
24	56735	PLUG RUBBER	
25	56812	COVER,CONTROL PANEL AC	
26	56809	DIVIDER,CONTROL PANEL	
27	56847	FAN ASSY,PANEL	
28	56849	GUARD,56874 FAN	
29	56783	COVER,CONTROL PANEL DC	
30	56850	WASHER 0.149ID	
31	56851	LOCKWASHER #6	
32	56852	SCREW 6-32 SS	
33	56760	STRAP,DUCT GEN EXHAUST	
34	31784	WASHER M 6	
35	31783	LOCKWASHER M 6	
36	13590	CAPSCREW M 6x30	
37	56871	DUCT ASSY,GEN EXHAUST	

(CONTINUED NEXT PAGE)

(PARTS LIST CONTINUED)

REF	PART #	PART NAME	NOTES
38	56767	SEAL,DUCT	
39	56778	SEAL,GEN INLET	
40	56920	COVER ASSY,GENERATOR	
41	56737	HOSE,VENCL TO EXH ELBOW	
42	56736	HOSE,HEAT EXGR TO VENCL	
43	301083	CLAMP,HOSE 10	
44	56733	ELBOW	
45	56839	WASHER	
46	43094	RIVET,POP 1/8DIA	
47A	56868	FLANGE ASSY	SIDEX MODELS
47B	56869	FLANGE ASSY	REARX MODELS
48A	56775	SEAL,EXH HOSE	SIDEX MODELS
48B	56776	SEAL,EXH HOSE	REARX MODELS
49	55812	WASHER M 6 SS	
50	55847	LOCKWASHER M 6 SS	
51	56842	CAPSCREW M 6x25	
52	56928	CAPSCREW M 6x16 SS	
53	56793	HOSE,SIPHON BREAK	
54	56773	LINE,FUEL	
55	55725	PUMP,FUEL	
56	56763	LINE,FUEL	
57	54500	VALVE,DIVERTER	
58	56761	MODULE,FUEL PUMP ASSY	

COMMON PARTS

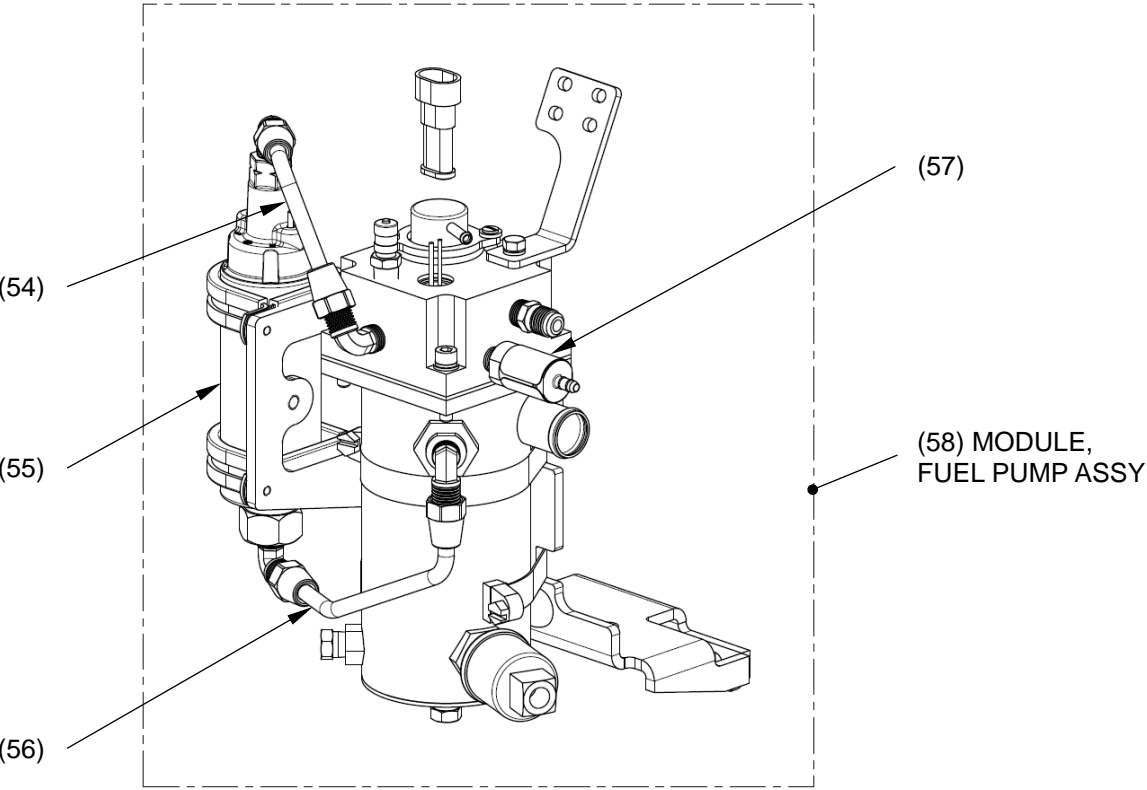
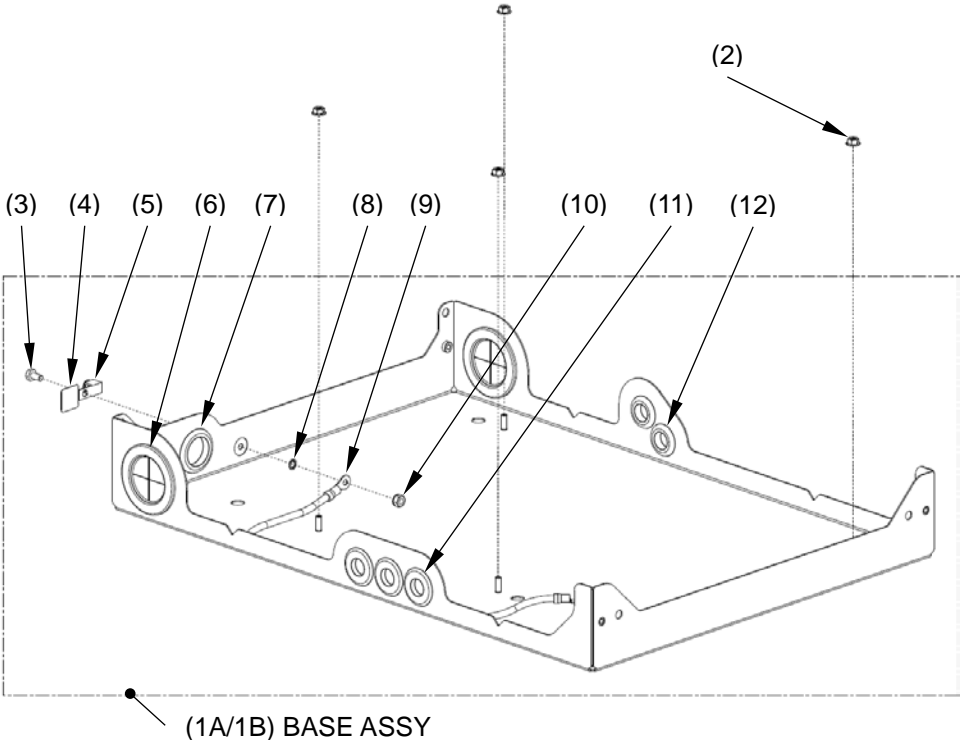

(18) PANEL,SERVICE

(19)

(20)

(21)

(22)

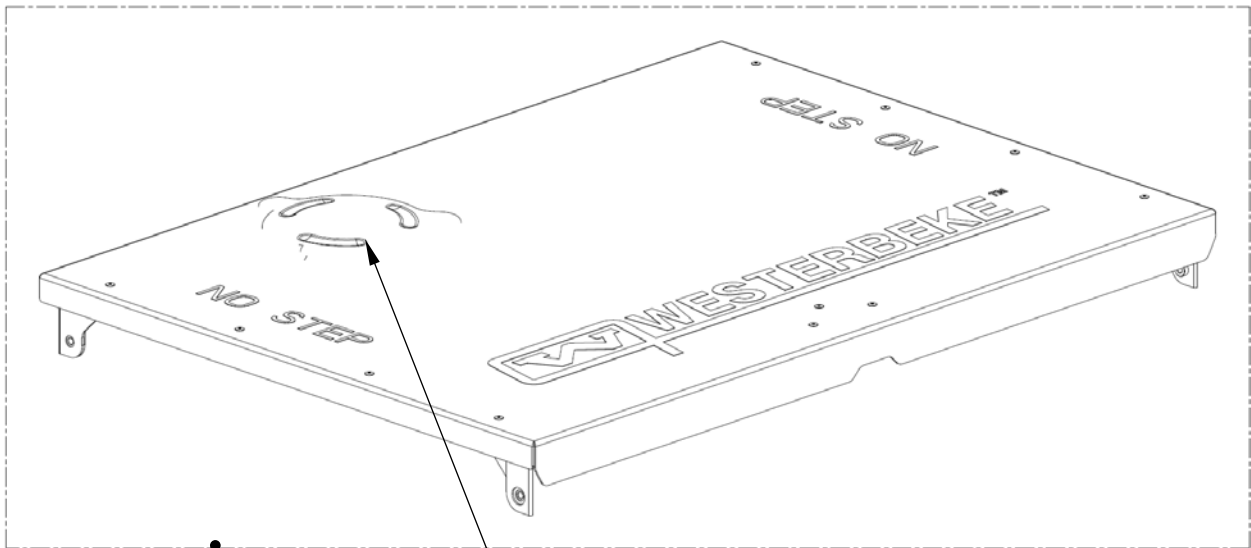
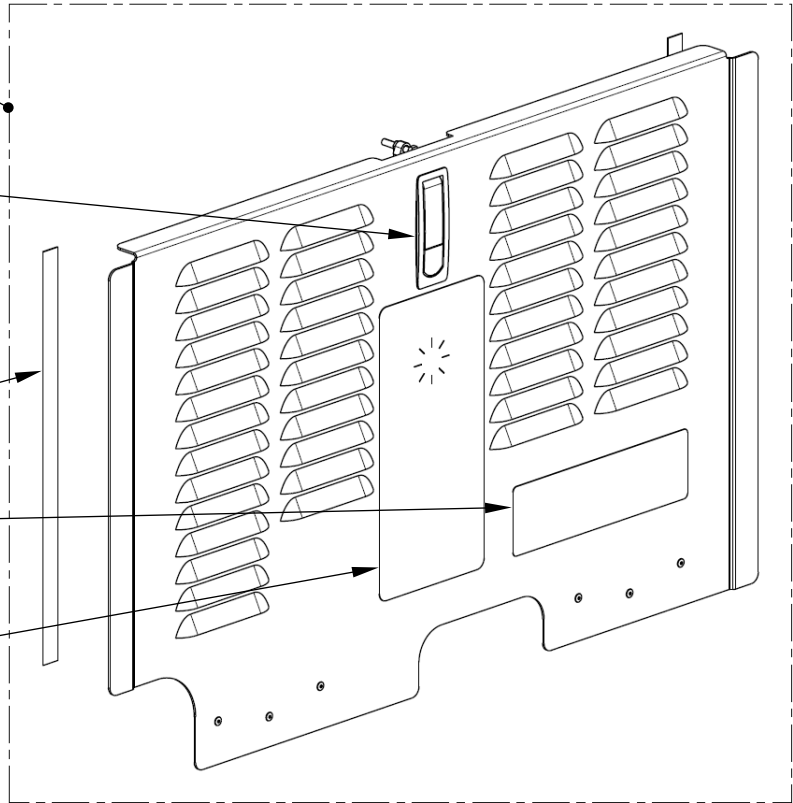

(23) PANEL, TOP

(24)

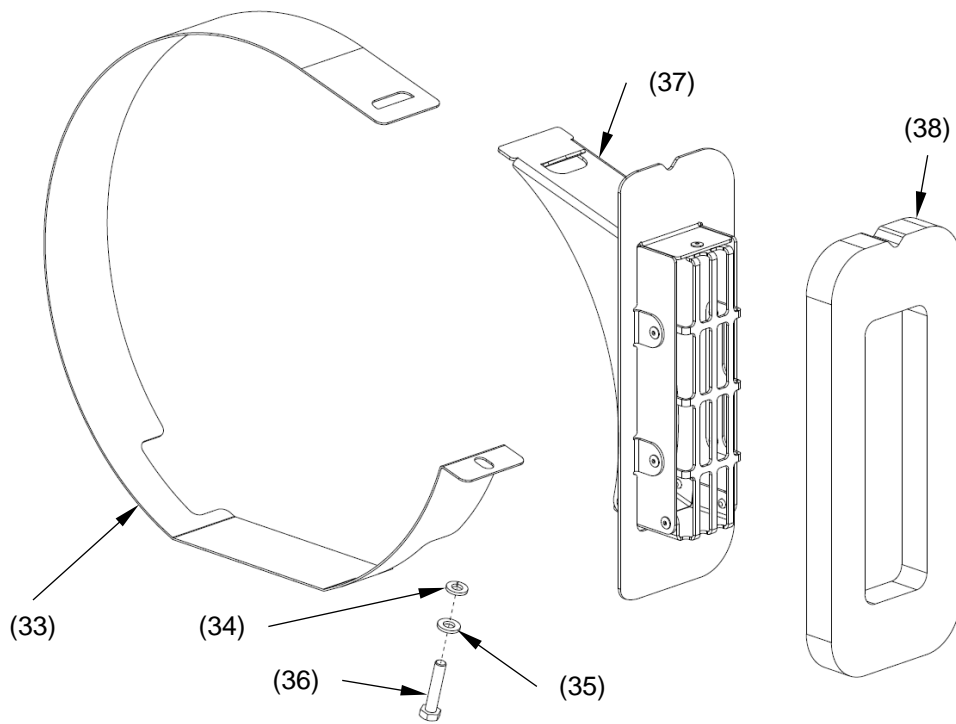
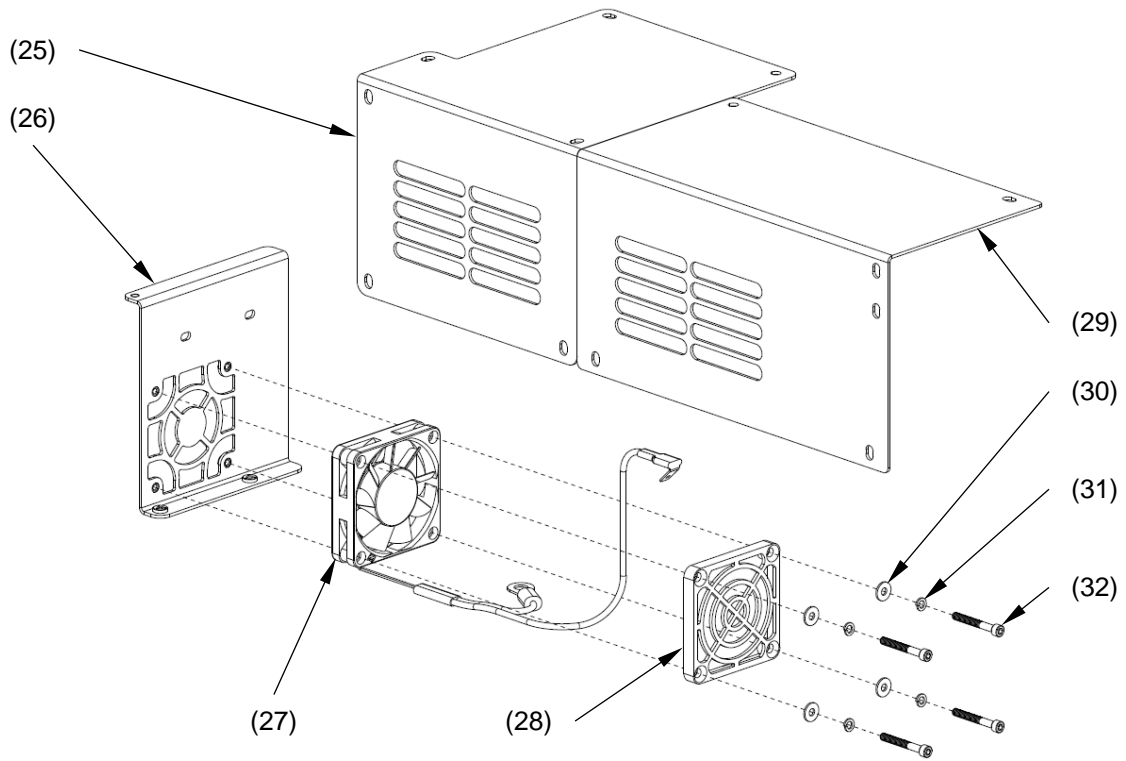

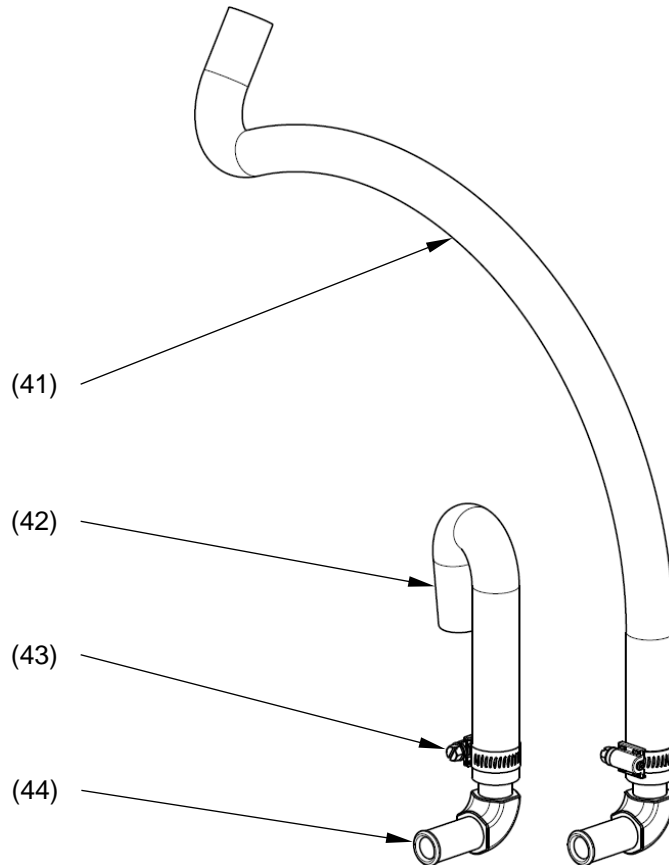
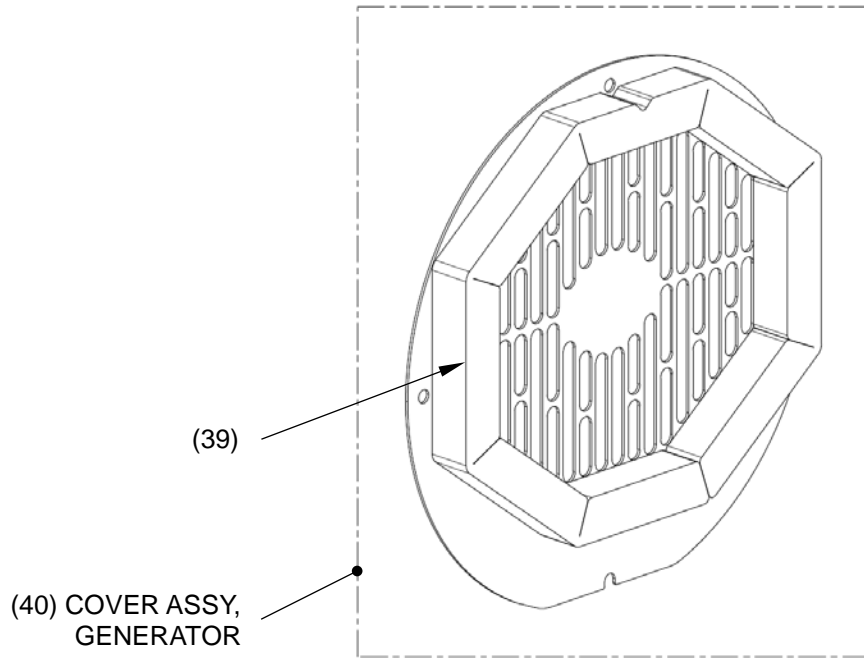

PARTS FOR SIDE EXHAUST (SIDEX) MODELS

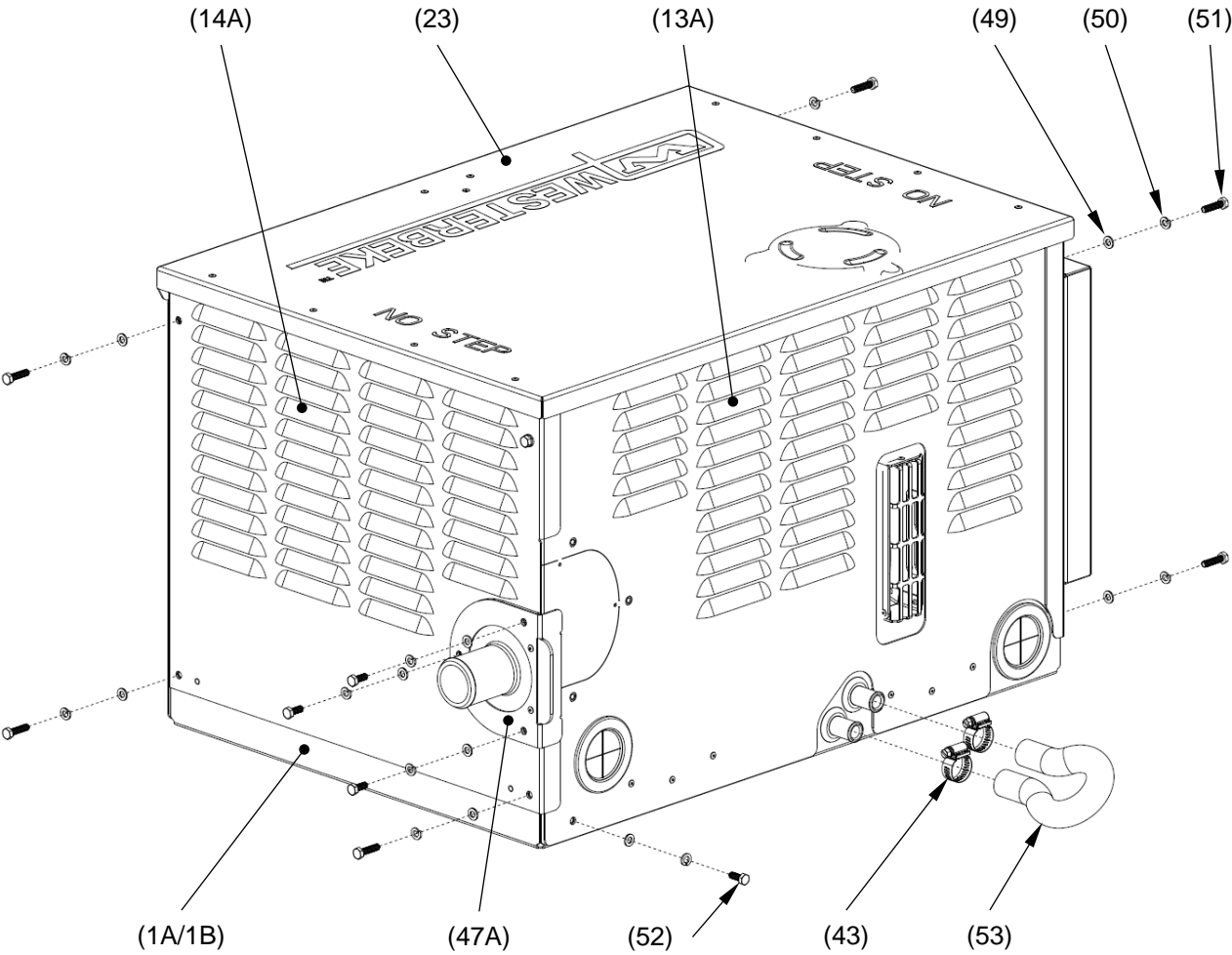

(13A) PANEL,REAR

(6)

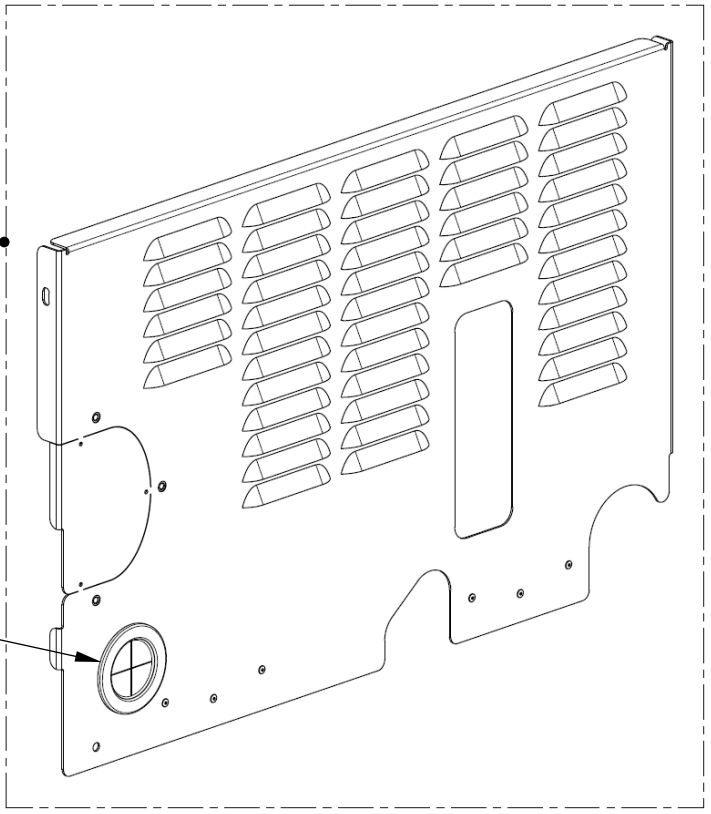

(14A) PANEL,BELT END

(15)

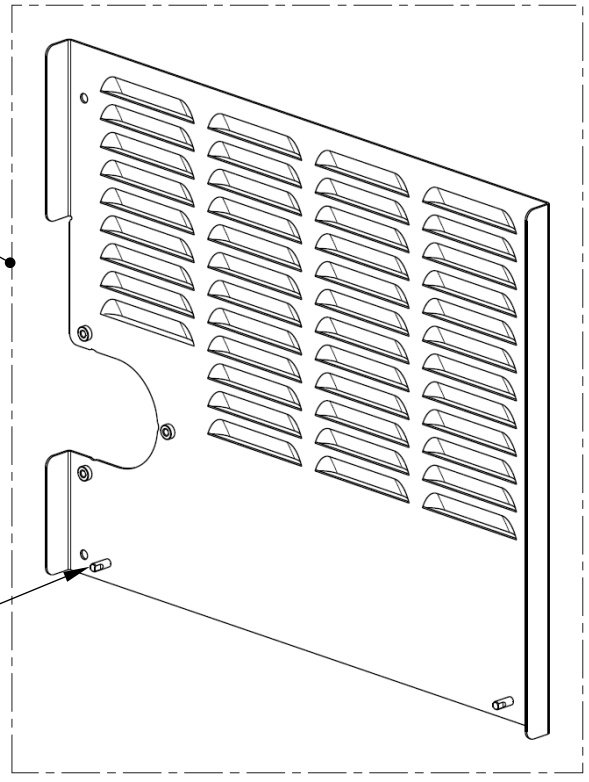

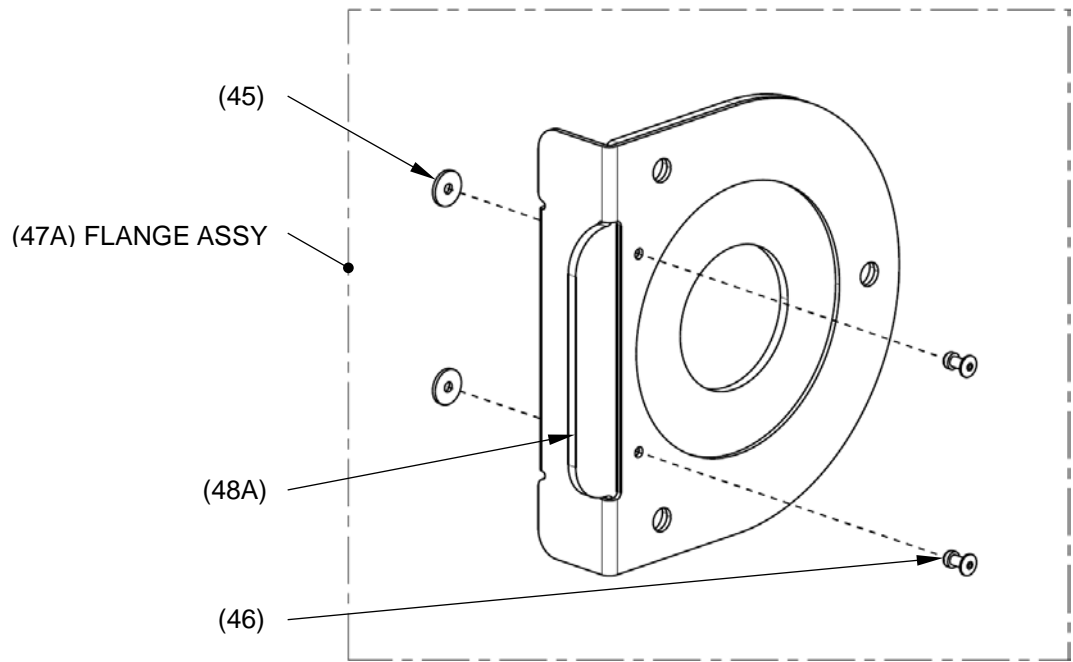

PARTS FOR REAR EXHAUST (REARX) MODELS

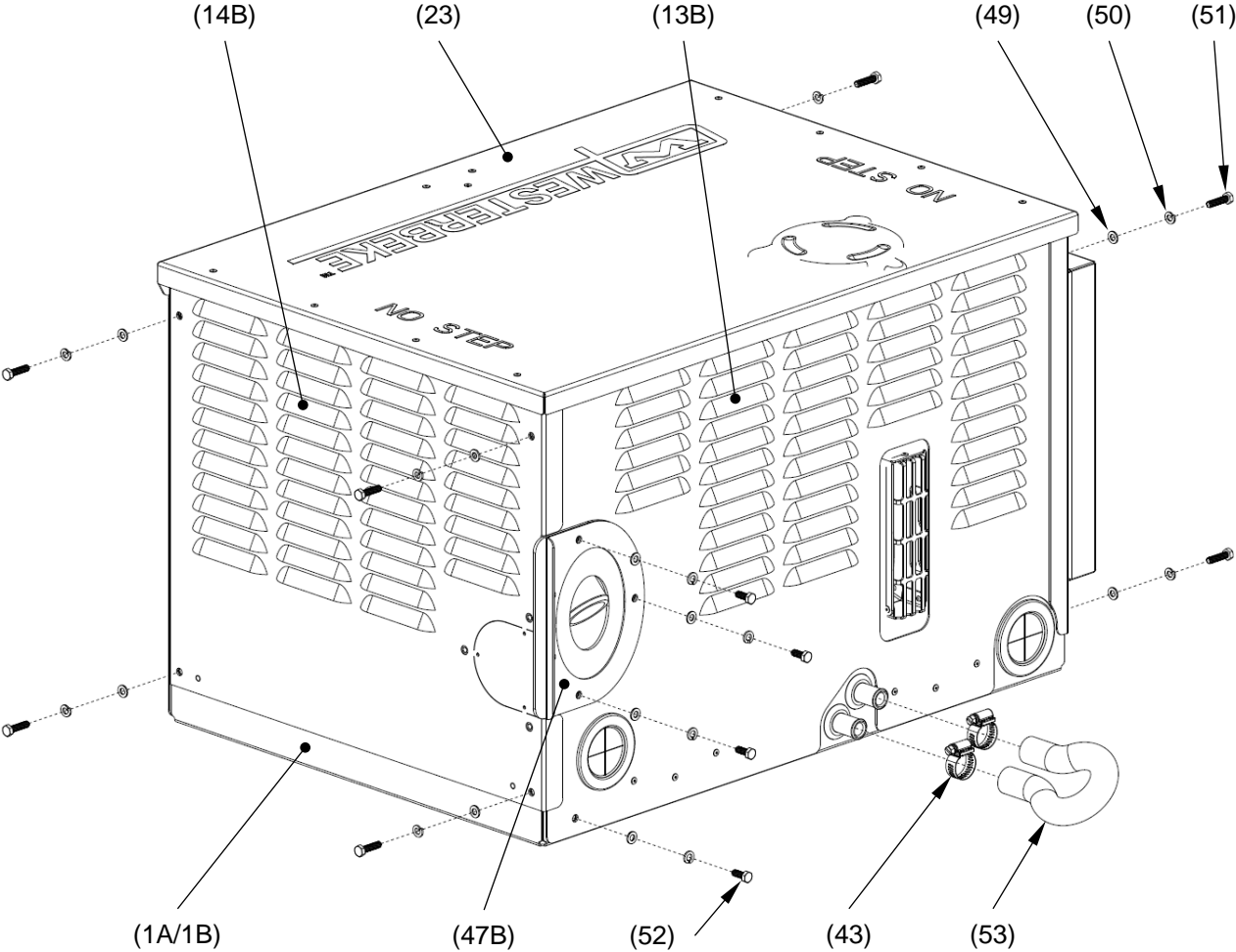

(13B) PANEL,REAR

(6)

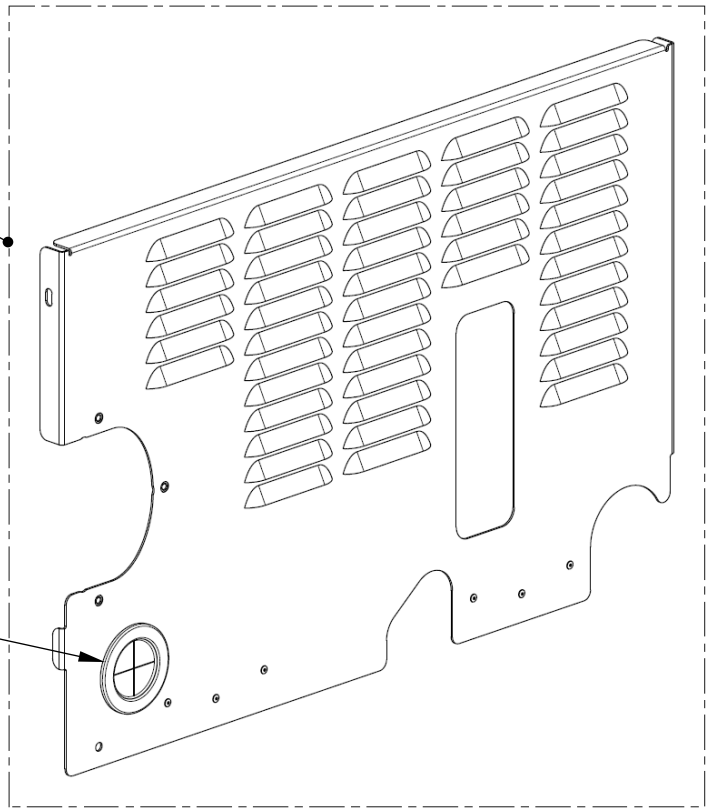

(14B) PANEL,BELT END

(15)

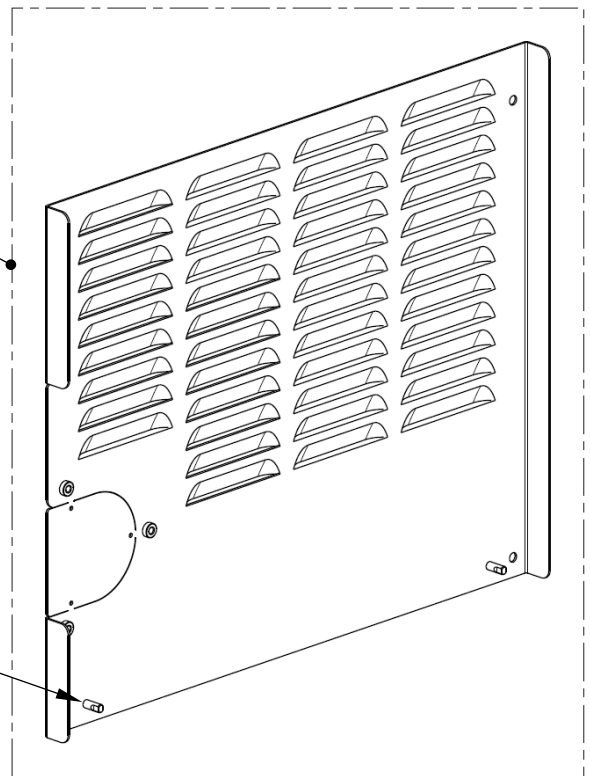

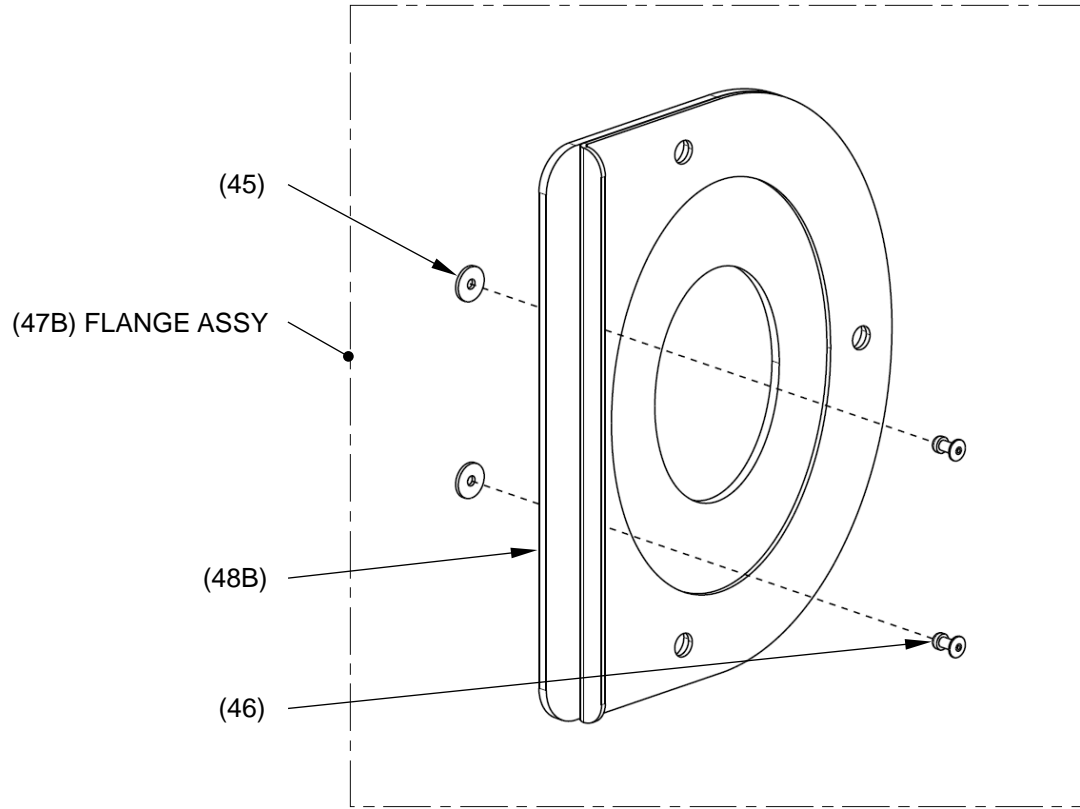

PARTS FOR 7.5 (60HZ) / 6.2 (50HZ) MCGA MODELS

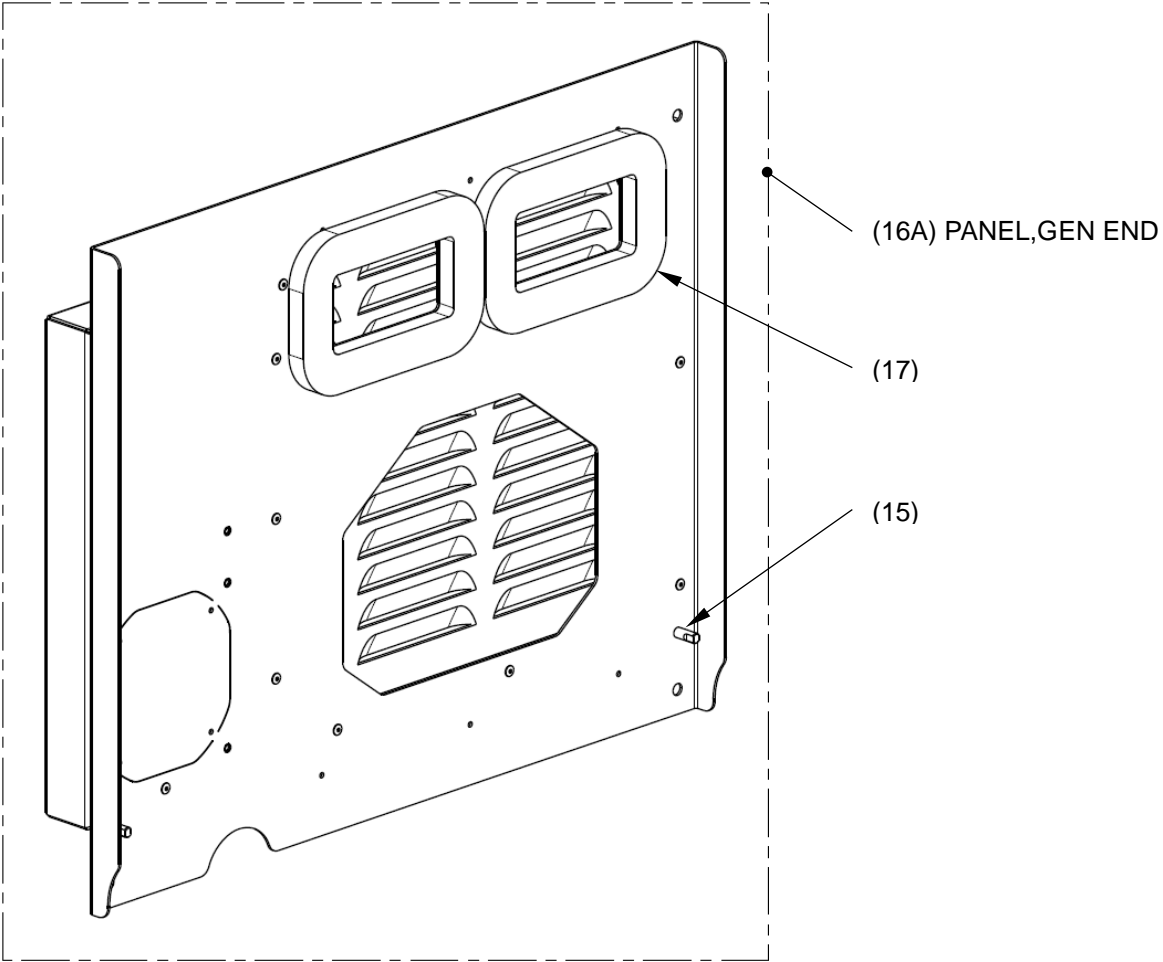

PARTS FOR 5.0 (60HZ) / 4.2 (50HZ) MCGA MODELS

